

SERIES

ModuleX[®] 100

FUNCTION

Adjustable downlight

CAT. No

SL-B9651H/CE

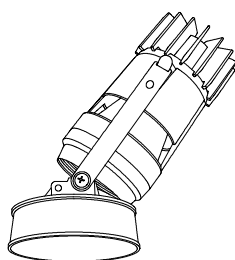

SPECIFICATION

- Light Source LED Module (Mounted)
- Light Distribution N=Narrow, M=Medium
- Cone White Cone(WC)
Matte Black Cone(MC)
Natural Cone(NC)
- Approved Driver Constant current (Sold separately)
- Fixture Input Voltage 38.6V
- Fixture Input Current 0.7A MAX
- Weight 510g
- Attached Safety Wire

PRODUCT CODE

SL-B9651H/CE/N·M/R27B/NC·MC·WC
SL-B9651H/CE/N·M/R30B/NC·MC·WC
SL-B9651H/CE/N·M/R35B/NC·MC·WC
SL-B9651H/CE/N·M/R40B/NC·MC·WC

OPTION (1 filter attachable)

Diffusion Lens SA-3DL03
Wide Diffusion Lens SA-3DF01
Spread Lens SA-3SP01
Honeycomb Louver SA-3HC02
Conversion Filter SA-3CV02-03
Edge control Filter SA-3EC01
Sharpener SA-3SH01
(available only for narrow distribution)

Unit: mm

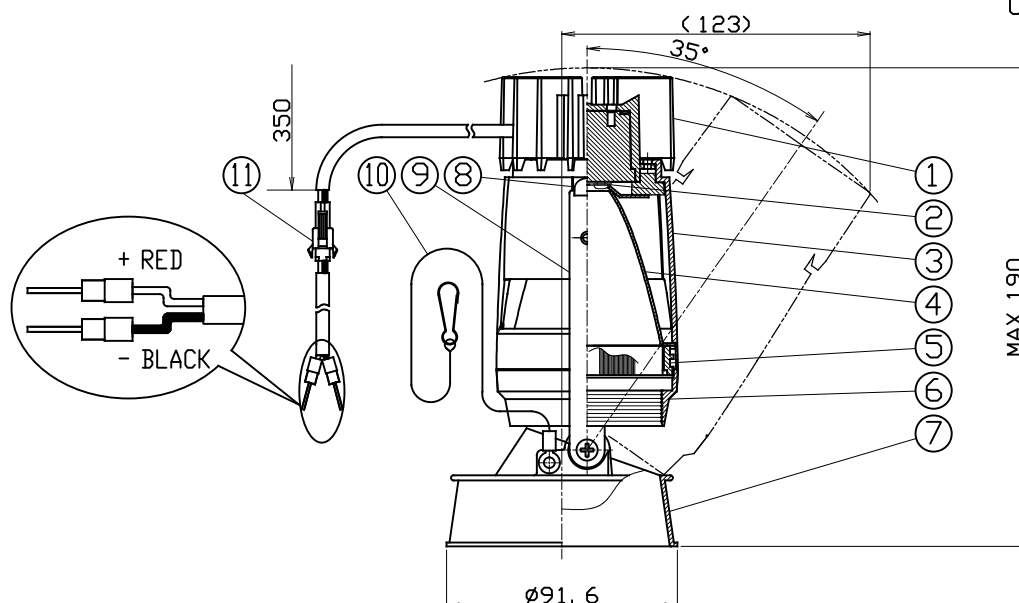

	PARTS	MATERIAL	REMARK
1	Socket Holder	ADC	Material-Origin Color
2	LED Module	_____	_____
3	Body	ADC	Material-Origin Color
4	Reflector	Aluminum	_____
5	Attachment Ring	ADC	Acrylic Baking Finish
6	Hood	ADC	Acrylic Baking Finish
7	Cone	ADC	Acrylic Baking Finish(WC·DC) Plating Finish(NC)
8	Joint	Stainless Steel	_____
9	Arm	Steel Plate	_____
10	Safety Wire	Stainless Steel	_____
11	Safety Connector	Resin	_____

ATTENTION

- Emission color and brightness would be different even within the same model.
- Danger! Do not remodel fixtures.
- Do not cover fixtures with the heat insulator etc.
- Keep distance of the fixtures and objects 0.2m or more.
- Use within 0℃~35℃ ambient temperature range.
- Remove the hood downward.
- Connect a safety wire to the fixture and mounting frame directly.
- Please use constant current driver.
- Connect input-side power wire to the approved driver directly.
- Please do not remove safety connector.

ModuleX[®]
ModuleX Inc.

SPECIFICATION SHEET

SCALE
1 / 3

CREATED DATE
28/12/2017

REVISION DATE