

Discontinued product

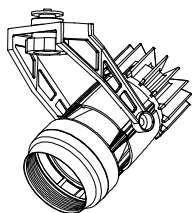

SPECIFICATION

- Light Source LED Module (Mounted)
- Light Distribution Narrow(N), Medium(M)
- Body Matte black(M)
- Dimming method 0-10V
- Input Voltage 220V±6%, 240V±6%(Dedicated driver input voltage)
- Input Current 0.155A (Dedicated driver input voltage, 220V input)
0.143A (Dedicated driver input voltage, 240V input)
- Power Consumption 30.7W (Included dedicated driver, 220V input)
30.9W (Included dedicated driver, 240V input)
- *The power consumption is measured based on the measuring method, JIS C 8105-3.
- Dedicated Driver Constant current (50/60Hz shared)
- Fixture Input Voltage 38.6V
- Fixture Input Current 0.7A
- Dimming signal input current 2mA
- Weight 620g (Driver weight is included)

PRODUCT CODE

SX-900LE/Z102/N-M/R27B/M
SX-900LE/Z102/N-M/R30B/M
SX-900LE/Z102/N-M/R35B/M
SX-900LE/Z102/N-M/R40B/M

OPTION (1 filter attachable)

Diffusion Lens SA-3DL03
Wide Diffusion Lens SA-3DF01
Spread Lens SA-3SP01
Honeycomb Louver SA-3HC02
Conversion Filter SA-3CV02~03
Edge control Filter SA-3EC01
Sharpener SA-3SH01

(available only for narrow distribution)

⑨ W: 170, D: 54, H: 28 190g

with terminal block for dimming signal wire
electric wire specified: CPEV-1P Ø0.9~Ø1.2

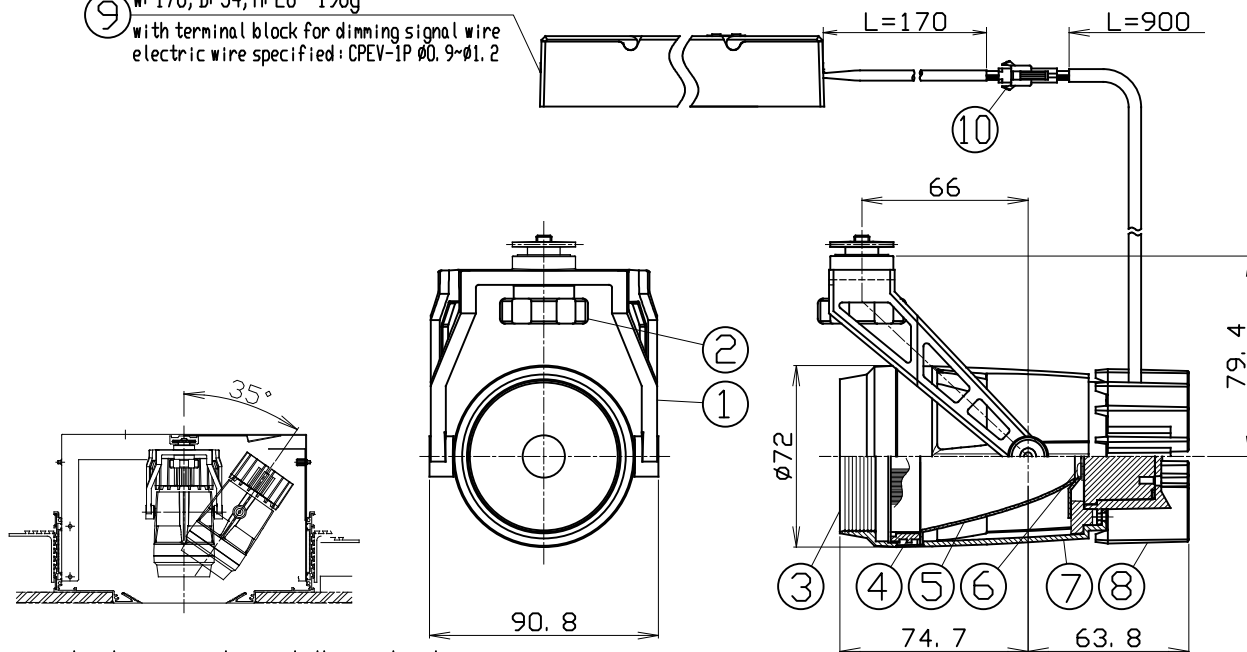

Maximum vertical aiming angle inside the mounting box

PARTS		MATERIAL	REMARK
1	Arm	ADC	Acrylic Baking Finish
2	Grip Bolt		Black (M6)
3	Hood	Aluminum	
4	Attachment Ring	Resin	
5	Reflector	EPT Sponge	Black
6	LED Module	ADC	Plating Finish
7	Body	ADC	Acrylic Baking Finish
8	Socket Holder	Stainless Steel	
9	Dedicated Driver		0-10V control dimming system
10	Safety connector	Resin	

ATTENTION

- Danger! Do not remodel the fixture.
- Use within 0~35℃ ambient temperature range.
- To remove the hood, remove it with the hood facing down.
- Please use constant current driver.
- Do not cover the fixture with a heat insulator etc.
- Because there are variations in the LEDs, emission color and brightness would be different even within the same model.
- Do not use a radio or TV near the fixture. The unit may generate noise in the radio or TV.
- When connecting to the electric circuit, calculate the capacity in accordance with JIS C8155 standard.
- Please use constant current driver.
- There is no sending terminal block on the dedicated driver (primary side).
- Connect input-side power wire to the dedicated driver directly.
- Keep distance of the fixture and objects 0.2m or more.
- Check the corresponding linear box.
- Use 0-10V control dimming system (SR-2830AS-1-10V(Sold separately)) only.

