

SPECIFICATION

• Light Source	LED Module(Mounted)
• Frame	White(W), Matte black(M)
• Vertical Aiming Angle	MAX90°
• Horizontal Aiming Angle	355°
• Dedicated Driver	Constant current (50/60Hz shared)
• Fixture Input Voltage	9.6V
• Fixture Input Current	0.48A (0.5A MAX)
• Weight	200g

PRODUCT CODE

SX-016PD/N/R27B/W·M/CE
SX-016PD/N/R30B/W·M/CE
SX-016PD/N/R35B/W·M/CE
SX-016PD/N/R40B/W·M/CE

(mm)

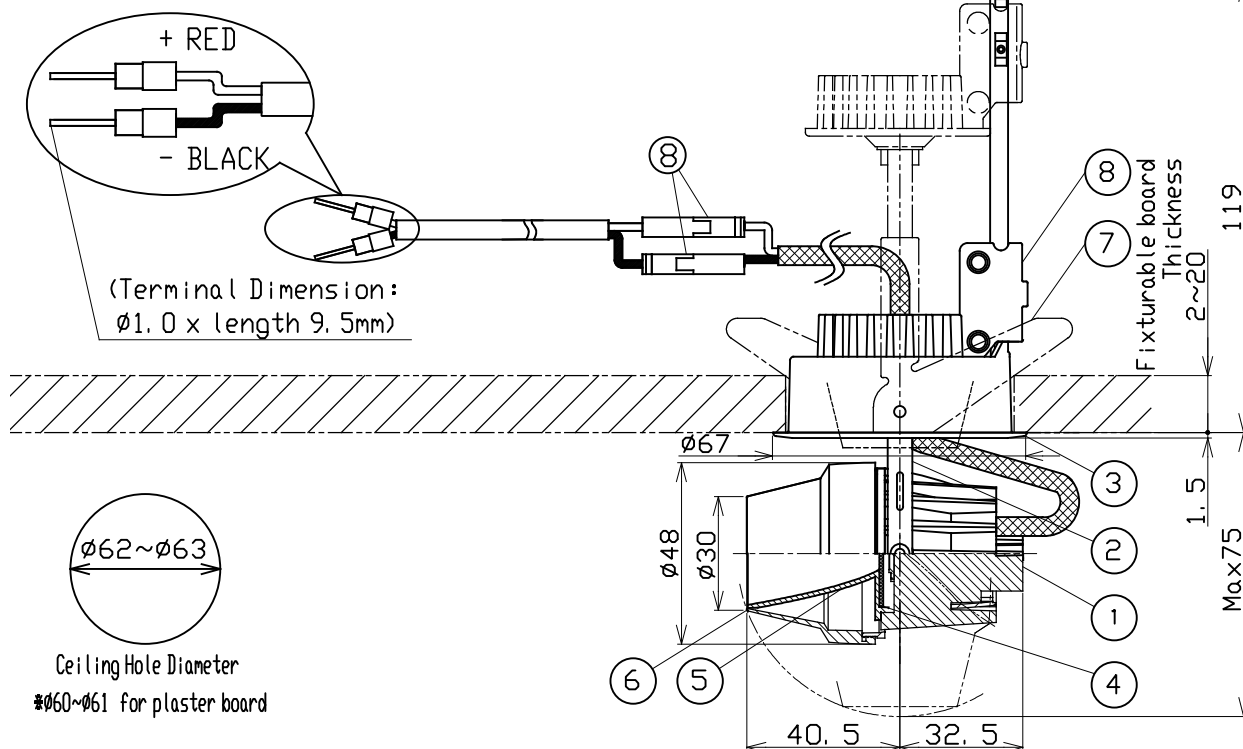

	PARTS	MATERIAL	REMARK
1	Body	ADC	Acrylic Baking Finish
2	Arm	Zinc ADC	Acrylic Baking Finish
3	Frame	Zinc ADC	Acrylic Baking Finish
4	Filter	Resin	
5	Active reflector	Resin	Vapor deposition
6	Hood	ADC	Acrylic Baking Finish
7	Unit Mounting Spring	Stainless Steel	
8	Flange	Resin	
9	Safety Connector	Resin	

ATTENTION

- Do not cover fixtures with the heat insulator etc.
- Please use constant current driver.
- Connect input-side power wire to the approved driver directly.
- Danger! Do not remodel fixtures.
- Use within 0~35℃ ambient temperature range.
- Emission color and brightness would be different even within the same model.
- Keep distance of the fixtures and objects 0.1m or more.
- Please do not remove safety connector.
- This equipment is a ceiling installation exclusive equipment. It can not be mounted on an inclined ceiling or wall.
- Please use the "class2" driver.
In that case, grounding is not required.