

SPECIFICATION

- Light Source LED Module (Mounted)
- Body White(WC), Matte black(MC), Silver(SC)
- Frame White(W), Matte black(M)
- Light Distribution N=Narrow, M=Medium
- Vertical aiming angle Upper10°, Lower90°
- Horizontal aiming angle 360°
- Fixture Input Voltage 37, 9V
- Fixture Input Current 0.9A (MAX)
- Dedicated Driver Constant current (50/60Hz shared)
- Weight 900g
- Attached Safety Wire
- tool for tilt lock is equipped

PRODUCT CODE

MMP-100D/3H/WCW/N·M/30B27/DL/3
 MMP-100D/3H/WCW/N·M/30B30/DL/3
 MMP-100D/3H/WCW/N·M/30B35/DL/3
 MMP-100D/3H/WCW/N·M/30B40/DL/3
 MMP-100D/3H/MCM/N·M/30B27/DL/3
 MMP-100D/3H/MCM/N·M/30B30/DL/3
 MMP-100D/3H/MCM/N·M/30B35/DL/3
 MMP-100D/3H/MCM/N·M/30B40/DL/3
 MMP-100D/3H/SCW·SCM/N·M/30B27/DL/3
 MMP-100D/3H/SCW·SCM/N·M/30B30/DL/3
 MMP-100D/3H/SCW·SCM/N·M/30B35/DL/3
 MMP-100D/3H/SCW·SCM/N·M/30B40/DL/3

OPTION

Full Spread Lens Filter MLA-100/SF01
 Semi Spread Lens Filter MLA-100/SS01
 Full Diffuser Lens Filter MLA-100/DF01
 Semi Diffuser Lens Filter MLA-100/DS02
 Edge Control Lens Filters MLA-100/EC02
 Sharpener Lens MLA-100/SH01
 (Narrow only)

(mm)

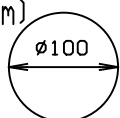

Ceiling Hole Diameter

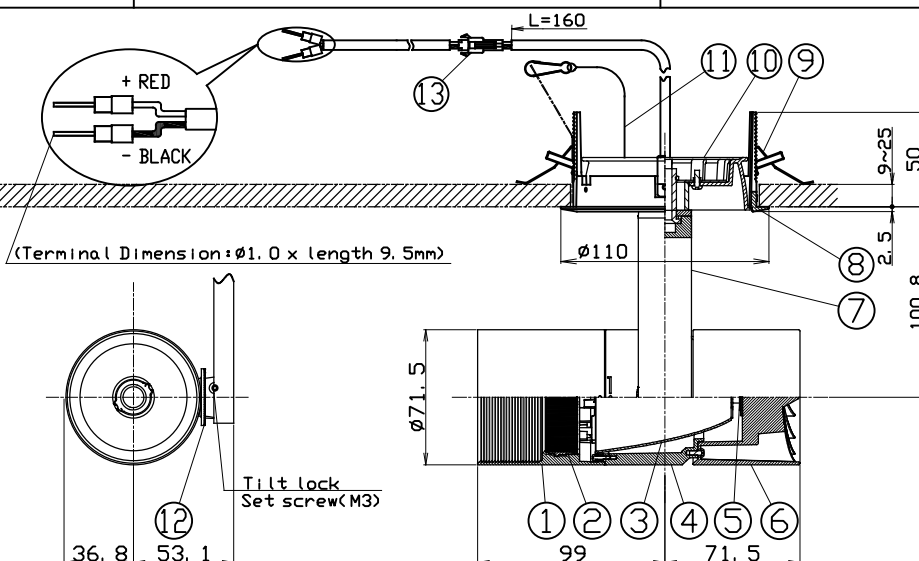

	PARTS	MATERIAL	REMARK
1	Hood	ADC	Acrylic Baking Finish
2	Option Holder	ADC	Acrylic Baking Finish
3	Reflector	Aluminum	
4	Body	ADC	Acrylic Baking Finish
5	LED Module		
6	Socket Holder	ADC	Acrylic Baking Finish
7	Arm	ADC	Acrylic Baking Finish
8	Cone	ADC	Acrylic Baking Finish
9	Mounting Frame	ADC	Acrylic Baking Finish
10	Unit Mounting Spring	Stainless Steel	
11	Safety Wire	Stainless Steel	
12	Tilt Protractor	Resin	
13	Safety Connector	Resin	

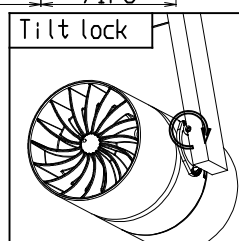

ATTENTION

- Emission color and brightness would be different even within the same model.
- Do not use a radio or TV near the fixtures. The unit may generate noise in the radio or TV.
- Danger! Do not remodel fixtures.
- Please use constant current driver.
- Connect input-side power wire to the dedicated driver directly.
- Use within 0°~35° ambient temperature range.
- Keep distance of the fixtures and objects 0.3m or more.
- Connect a safety wire to the fixture and mounting frame directly.
- Please do not move the fixture body under the situation the tilt lock works.
- Please do not unfasten the set crew for tilt lock too much. Otherwise, it may be dropped and lost.
- Please do not remove safety connector
- Please use the 'class2' driver. In that case, grounding is not required.