

SPECIFICATION

- Light Source LED Module (Mounted)
- Body Color White (WC*)
Matte Black (ML*)
Silver (SC*)
- Frame Color White (W)
Matte Black (M)
- Distribution N=Narrow, M=Medium
- Tilt Angle Upper 10°, Lower 90°
- Pan Angle 360°
- Approved Driver Constant Current (Sold Separately)
- Fixture Input Voltage 36.9V
- Fixture Input Current 0.48A (0.5A Max)
- Weight 540g
- Attached Safety Wire

PRODUCT CODE

MMP-080D/3H/WCW/N・M/10B27/DL/3
MMP-080D/3H/WCW/N・M/10B30/DL/3
MMP-080D/3H/WCW/N・M/10B35/DL/3
MMP-080D/3H/WCW/N・M/10B40/DL/3
MMP-080D/3H/MCM/N・M/10B27/DL/3
MMP-080D/3H/MCM/N・M/10B30/DL/3
MMP-080D/3H/MCM/N・M/10B35/DL/3
MMP-080D/3H/MCM/N・M/10B40/DL/3
MMP-080D/3H/SCW・SCM/N・M/10B27/DL/3
MMP-080D/3H/SCW・SCM/N・M/10B30/DL/3
MMP-080D/3H/SCW・SCM/N・M/10B35/DL/3
MMP-080D/3H/SCW・SCM/N・M/10B40/DL/3

OPTION

Full Spread Lens MLA-080/SF01
Semi Spread Lens MLA-080/SS01
Full Diffuser Lens MLA-080/DF01
Semi Diffuser Lens MLA-080/DS02
Edge Control Lens MLA-080/EC01
Sharpener MLA-080/SH01
(for N distribution only)

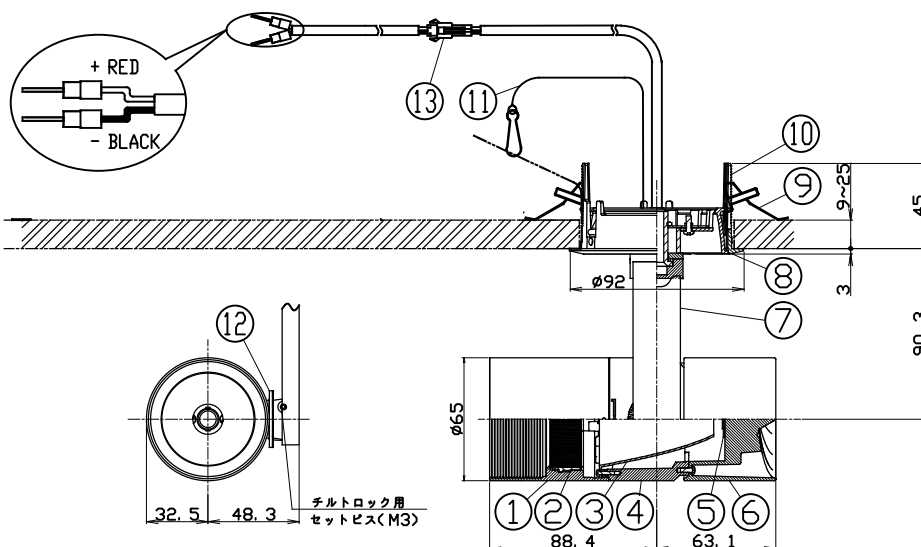
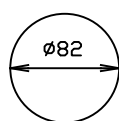

	PARTS	MATERIAL	REMARK
1	Hood	ADC	Acrylic Baking Finish
2	Option Holder	ADC	Acrylic Baking Finish
3	Reflector	Aluminum	
4	Body	ADC	Acrylic Baking Finish
5	LED Module		
6	Socket Holder	ADC	Acrylic Baking Finish
7	Arm	ADC	Acrylic Baking Finish
8	Cone	ADC	Acrylic Baking Finish
9	Unit Mounting Spring	Stainless Steel	
10	Mounting Frame	ADC	Acrylic Baking Finish
11	Safety Wire	Stainless Steel	
12	Tilt Protractor	Resin	
13	Safety Connector	Resin	

ATTENTION

- Danger! Do not remodel fixtures.
- Emission color and brightness would be different even within the same model.
- Do not use a radio or TV near the fixtures. The unit may generate noise in the radio or TV.
- Use within 0℃~35℃ ambient temperature range
- Do not cover fixtures with the heat insulator etc.
- Keep distance of the fixtures and objects 0.2m or more.
- Connect input-side power wire to the approved driver directly.
- Connect a safety wire to the fixture and mounting frame directly.
- Please use the constant current driver.
- Please do not remove safety connector

