

SPECIFICATION

- Light Source LED Module (Mounted)
- Light Distribution Wide (W) , Medium (M)
- Cone White Cone (WC)
- Matte black Cone (MC)
- Chrome Cone (CC)
- Frame White (SWF) , Matte black (SMF)
- Dedicated Driver Constant current (Sold Separately)
- Fixture Input Voltage 36, 9V
- Fixture Input Current 0.48A
- Weight 160g
- Attached Safety Wire
- tool for pan/tilt lock is equipped

PRODUCT CODE

MMP-060F/WC/FLF/W·M/10A24/DL/3
MMP-060F/WC/FLF/W·M/10A27/DL/3
MMP-060F/WC/FLF/W·M/10A30/DL/3
MMP-060F/WC/FLF/W·M/10A35/DL/3
MMP-060F/WC/FLF/W·M/10A40/DL/3
MMP-060F/MC/FLF/W·M/10A24/DL/3
MMP-060F/MC/FLF/W·M/10A27/DL/3
MMP-060F/MC/FLF/W·M/10A30/DL/3
MMP-060F/MC/FLF/W·M/10A35/DL/3
MMP-060F/MC/FLF/W·M/10A40/DL/3
MMP-060F/CC/FLF/W·M/10A24/DL/3
MMP-060F/CC/FLF/W·M/10A27/DL/3
MMP-060F/CC/FLF/W·M/10A30/DL/3
MMP-060F/CC/FLF/W·M/10A35/DL/3
MMP-060F/CC/FLF/W·M/10A40/DL/3

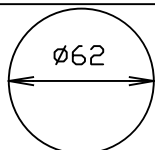

*In case of gypsum board: ø61~ø62
Aluminum, stainless steel material: ø61.5~ø62

Ceiling Hole Diameter

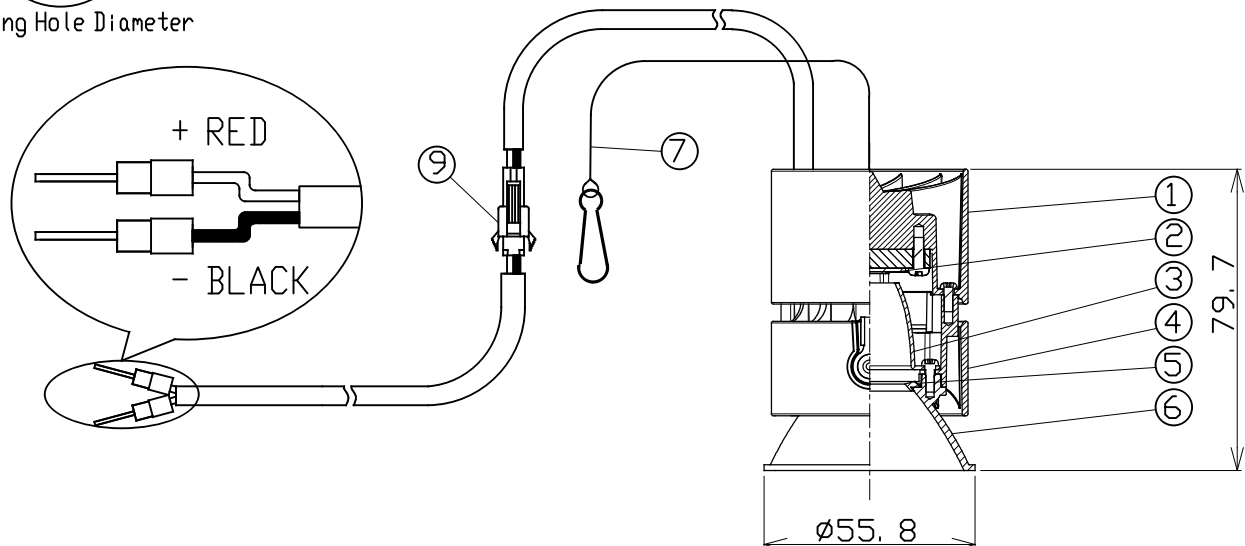

	PARTS	MATERIAL	REMARK
1	Socket Holder	ADC	Acrylic Baking Finish
2	LED Module		
3	Reflector	Aluminum	
4	Body	ADC	Acrylic Baking Finish
5	Glare Cut Ring	Silicon	
6	Cone	ADC	Acrylic Baking Finish (WC·MC) Plating Finish (CC)
7	Safety Wire	Stainless Steel	
8	Safety Connector	Resin	

ATTENTION

- Do not cover fixtures with the heat insulator etc.
- Use the dedicated driver only.
- Connect input-side power wire to the dedicated driver directly.
- Danger! Do not remodel fixtures.
- Use within 0~35℃ ambient temperature range
- Connect a safety wire to the fixture and mounting frame directly.
- Emission color and brightness would be different even within the same model.
- Do not use a radio or TV near the fixtures. The unit may generate noise in the radio or TV.
- calculate the capacity in accordance with JIS C8155 standard.
- The height of inside the ceiling have to be 140mm or more to install the driver there.
- This equipment is a ceiling installation exclusive equipment. It can not be mounted on an inclined ceiling or wall.
- Keep distance of the fixtures and objects 0.2m or more.
- Place the driver on the ceiling and attach the frame.
(Please be sure to check the instruction manual)