

**SPECIFICATION**

- Light Source
  - Light Distribution
  - Body
  - Corn
  - Flame
  - Vertical aiming angle
  - Horizontal aiming angle
  - Dedicated Driver
  - Fixture Input voltage
  - Fixture Input current
  - Weight
  - Safety Wire is attached
  - tool for pan/tilt lock is equipped
- LED Module (Mounted)  
Narrow(N), Medium(M)  
White(W), Matte black(M), Silver(S)  
White Corn(WC)  
Matte black Corn(MC)  
White(SWF), Matte black(SMF)  
Upper10°, Lower90°  
Constant current (50/60Hz shared)  
32.6V  
0.38A(MAX)  
215g

**PRODUCT CODE**

MMP-060D/3H/WCW/N·M/10A24/DL/3  
MMP-060D/3H/WCW/N·M/10A27/DL/3  
MMP-060D/3H/WCW/N·M/10A30/DL/3  
MMP-060D/3H/WCW/N·M/10A35/DL/3  
MMP-060D/3H/WCW/N·M/10A40/DL/3  
MMP-060D/3H/MCM/N·M/10A24/DL/3  
MMP-060D/3H/MCM/N·M/10A27/DL/3  
MMP-060D/3H/MCM/N·M/10A30/DL/3  
MMP-060D/3H/MCM/N·M/10A35/DL/3  
MMP-060D/3H/MCM/N·M/10A40/DL/3  
MMP-060D/3H/SWW·SMM/N·M/10A24/DL/3  
MMP-060D/3H/SWW·SMM/N·M/10A27/DL/3  
MMP-060D/3H/SWW·SMM/N·M/10A30/DL/3  
MMP-060D/3H/SWW·SMM/N·M/10A35/DL/3  
MMP-060D/3H/SWW·SMM/N·M/10A40/DL/3

**OPTION**

Full Diffuser Lens Filter MLA-060/DF01  
Semi Diffuser Lens Filter MLA-060/DS01  
Full Spread Lens Filter MLA-060/SF01  
Semi Spread Lens Filter MLA-060/SS01  
Edge Control Lens Filter MLA-060/EC01  
Sharpen Lens MLA-060/SH01  
(available only for narrow distribution)

[mm]

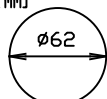

Ceiling Hole Diameter  
For gypsum boards 61 to 62  
For aluminum plates  
and stainless steel boards, 61 to 62

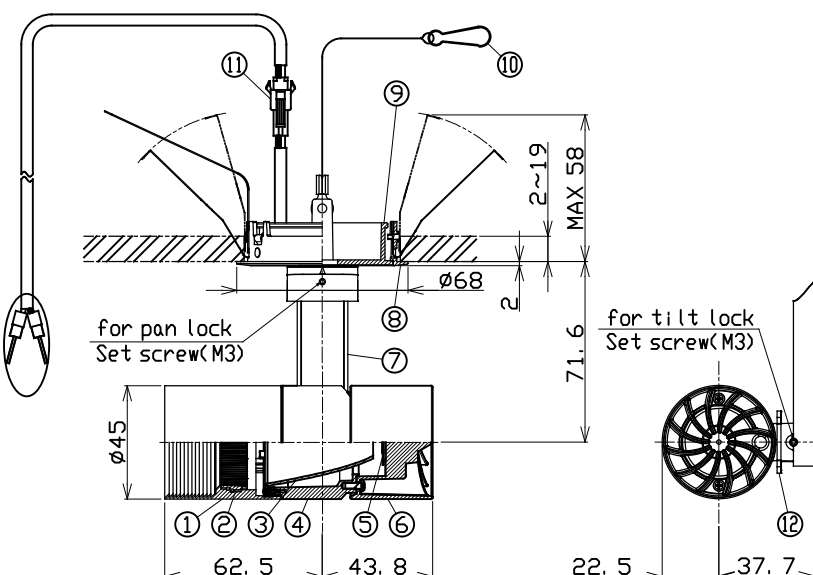
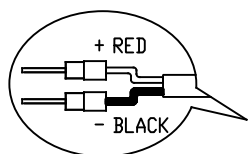

	PARTS	MATERIAL	REMARK
1	Hood	ADC	Acrylic Baking Finish
2	Option Holder	ADC	Acrylic Baking Finish
3	Reflector	Aluminum	
4	Body	ADC	Acrylic Baking Finish
5	LED Module		
6	Socket Holder	ADC	Acrylic Baking Finish
7	Arm	ADC	Acrylic Baking Finish
8	Mounting Frame	ADC	Acrylic Baking Finish
9	Cone	ADC	Acrylic Baking Finish
10	Safety Wire	Stainless Steel	
11	Safety Connector	Resin	
12	Tilt Protractor	Resin	

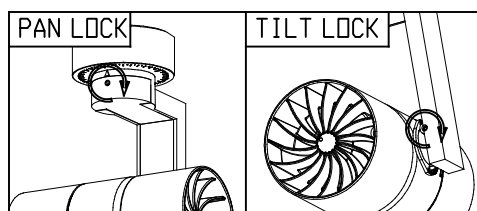

**ATTENTION**

- Emission color and brightness would be different even within the same model.
- Do not use a radio or TV near the lighting fixtures. The unit may generate noise in the radio or TV.
- Danger! Do not remodel fixtures.
- Do not cover the lighting fixture with insulation etc.
- Be sure to connect the included safety wire to the lighting fixture and frame.
- Keep distance of the fixtures and objects 0.1m or more.
- Use within 0°C~35°C ambient temperature range.
- Please do not move the fixture body under the situation the pan/tilt lock works.
- Please do not unfasten the set screw for pan/tilt lock too much. Otherwise, it may be dropped and lost.
- Install this lighting fixtures only on the ceiling. It can not be mounted on inclined ceilings or walls.
- Please do not irradiate the lighting fixtures upward. Dust accumulates in the light emitting part, which may cause fire.