

SERIES

FUNCTION

CAT, No.

GRID Quadrates®

FLAT PANEL

MGP-Q6FP/DL/BC1/F/60A35/DL/3

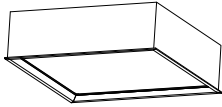

SPECIFICATION

- Light Source LED Module (Mounted)
- Light Distribution Light Guide Plate : Flood
- Approved Driver Constant current (Sold Separately)
- Fixture Input Voltage 74.1V
- Fixture Input Current 0.7A
- Weight 13.6kg

PRODUCT CODE

MGP-Q6FP/DL/BC1/F/60A35/DL/3

Board ceiling

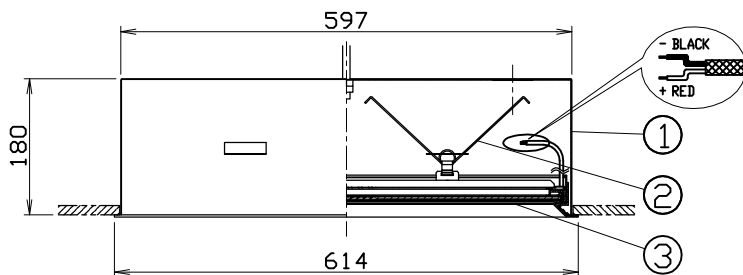
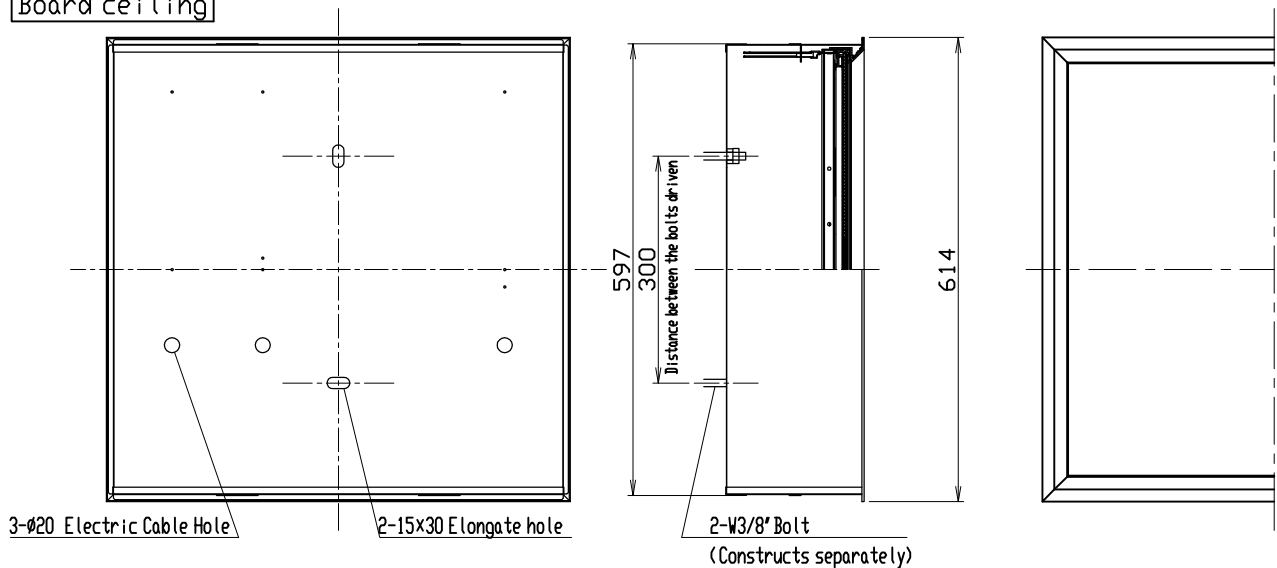

600×600
Ceiling Cut Out

	PARTS	MATERIAL	REMARK
1	Installation Box	Zinc copper plate	_____
2	V Spring	Spring material	_____
3	Acrylic	_____	_____

ATTENTION

- Use within 0°C~35°C ambient temperature range
- Do not cover fixtures with the heat insulator etc.
- Keep distance of the fixtures and objects 0.2m or more.
- Do not dismantle or remodel. Once it is dismantled, it cannot restore with original size.
- Do not use a radio or TV near the fixtures. The unit may generate noise in the radio or TV.
- Emission color and brightness would be different even within the same model.
- Please use constant current driver.
- Connect input-side power wire to the approved driver directly.
- There is a risk that it may be injured at the edge of a product. Be careful enough of handling.
- Please surely fix the installation. Unstable installation may bring the falling.
- Please refer to installation guide on how to install.

ModuleX
ModuleX Inc.

SPECIFICATION SHEET

SCALE
1 / 10

CREATED DATE
29/02/2016

REVISION DATE