

SPECIFICATION

- Light Source LED Module (Mounted)
- Light Distribution M=Medium
- Cone White Cone(WC)
- Matt black Cone(MC)
- Chrome Cone(CC)
- Approved Driver White (SWF), Matt Black (SMF)
- Approved Driver Constant current (Sold Separately)
- Fixture Input Voltage 36. 8V
- Fixture Input Current 0. 7A MAX
- Weight 440g
- Attached Safety Wire

PRODUCT CODE

- MMP-080F/WC/SWF・SMF/M/20B27/DL/3
 MMP-080F/WC/SWF・SMF/M/20B30/DL/3
 MMP-080F/WC/SWF・SMF/M/20B35/DL/3
 MMP-080F/WC/SWF・SMF/M/20B40/DL/3

 MMP-080F/MC/SWF・SMF/M/20B27/DL/3
 MMP-080F/MC/SWF・SMF/M/20B30/DL/3
 MMP-080F/MC/SWF・SMF/M/20B35/DL/3
 MMP-080F/MC/SWF・SMF/M/20B40/DL/3

 MMP-080F/CC/SWF・SMF/M/20B27/DL/3
 MMP-080F/CC/SWF・SMF/M/20B30/DL/3
 MMP-080F/CC/SWF・SMF/M/20B35/DL/3
 MMP-080F/CC/SWF・SMF/M/20B40/DL/3

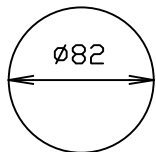

Ceiling Hole Diameter

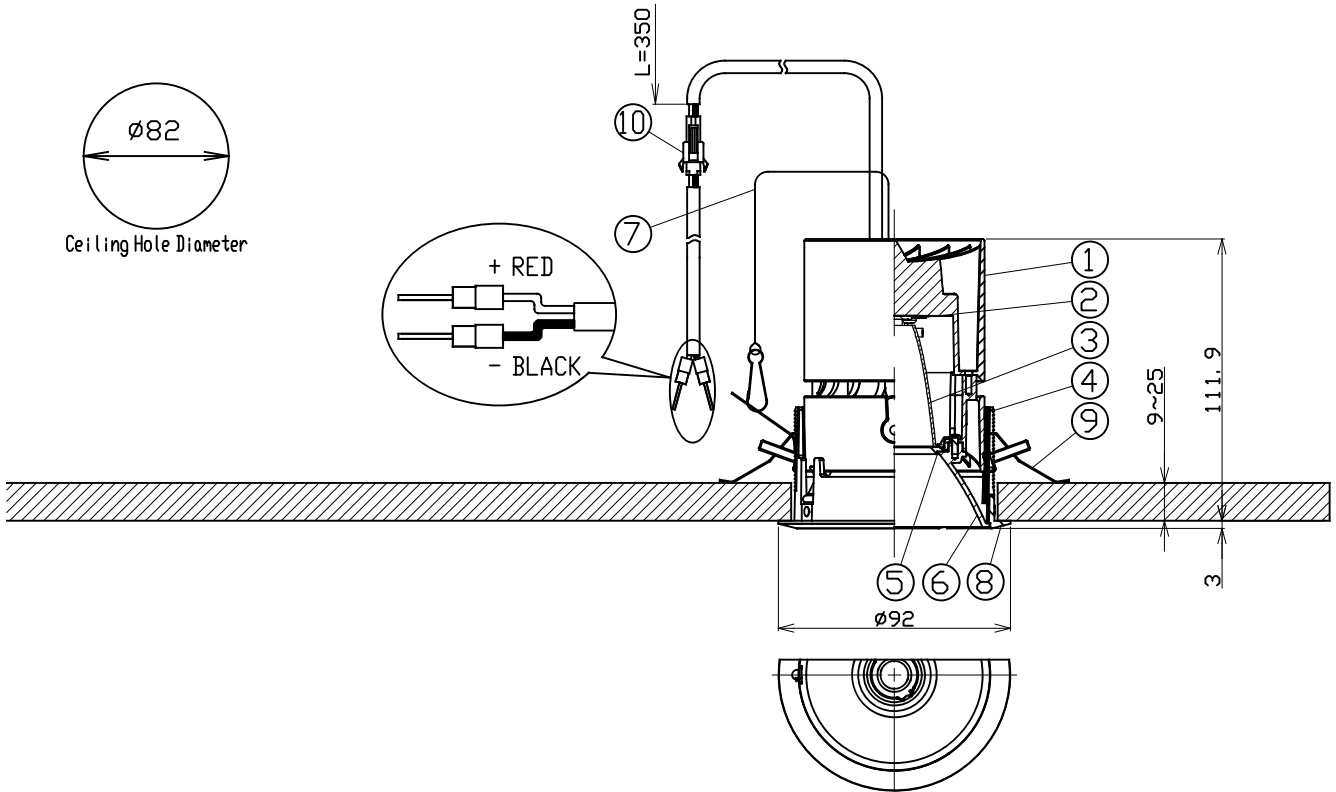

	PARTS	MATERIAL	REMARK
1	Socket Holder	ADC	Acrylic Baking Finish
2	LED Module		
3	Reflector	Aluminum	
4	Body	ADC	Acrylic Baking Finish
5	Glare Cut Ring	ADC	
6	Cone	ADC	WC, MC: Acrylic Baking Finish CC: Plating Finish
7	Safety Wire	Stainless Steel	
8	Mounting Frame	ADC	Acrylic Baking Finish
9	Unit Mounting Spring	Stainless Steel	
10	Safety Connector	Resin	

ATTENTION

- Use within 0℃~35℃ ambient temperature range
- Do not cover fixtures with the heat insulator etc.
- Keep distance of the fixtures and objects 0. 3m or more.
- Danger! Do not remodel fixtures.
- Do not use a radio or TV near the fixtures. The unit may generate noise in the radio or TV.
- Connect a safety wire to the fixture and mounting frame directly.
- Emission color and brightness would be different even within the same model.
- Use the constant current driver only.
- Connect input-side power wire to the Approved driver directly.
- Please do not remove safety connector